

D

C

B

A

D

C

B

A

# CONFIGURATION TABLE

DASH NUMBER	QUANTITY	MATERIAL	THICKNESS	DESCRIPTION
-02	1	BERGQUIST 5000 S35 .060	.060	GAP PAD, 2.18 X 1.50
-03	2	BERGQUIST 5000 S35 .060	.060	GAP PAD, .60 X .40
-04	1	BERGQUIST 5000 S35 .060	.060	GAP PAD, .90 X .63
-05	1	BERGQUIST 5000 S35 .060	.060	GAP PAD, .35 X .35

- NOTES:
- BAG AND TAG PART NUMBER AND REVISION WITH INDELIBLE INK, "MCH-2376-01 A1".
  - DIE CUT TEMPLATE CAN BE MADE TO CUT THE DIFFERENT MATERIALS. SCRAP MATERIAL CAN BE SAVED FOR ENGINEERING DEVELOPMENT.
  - CORNER RADIUS OR CHAMFER OF .020 ACCEPTABLE UPON SEPARATION OF PIECES.
  - THE 3D SOLID MODEL DIMENSIONS SUPERCEDES DIMENSIONS LISTED ON THE DRAWING. PARVUS ENGINEERING SHOULD BE CONSULTED IN ANY CASE OF UNCLARITY.
  - SEE PARVUS MRP FOR COMPLETE BOM INFORMATION.

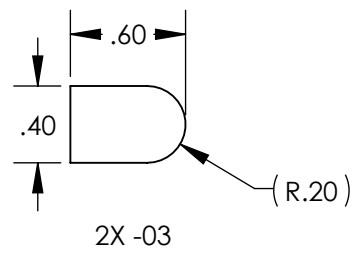
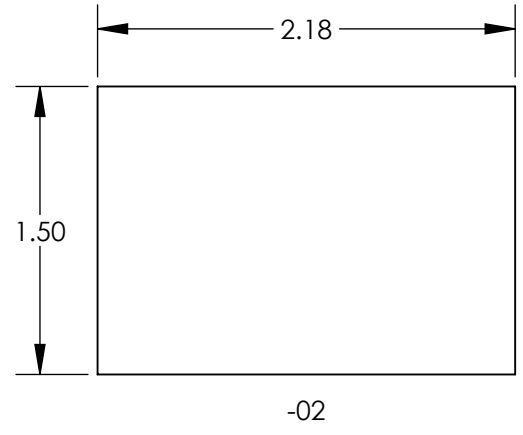
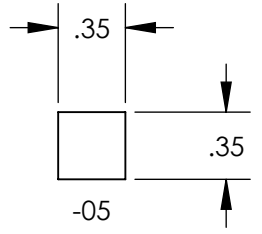
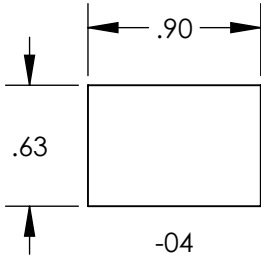

ECO: <b>4078</b>	DESIGNED BY <b>nworsley</b>	TOLERANCE UNLESS OTHERWISE SPECIFIED TOLERANCES ARE .X ± .1 .XX ± .03 .XXX ± .010 ANGLES ± 1° SURFACE FINISH: 63 μin RA PER ASME Y14.5M - 1994	DESCRIPTION <b>GAP PAD KIT, POWER SUPPLY, 5915</b>
CHANGE NOTES: <b>INITIAL RELEASE</b>		UNITS <b>DIMENSIONS ARE IN INCHES</b>	MATERIAL <b>PNL-0412-01, BERGQUIST 5000S35</b> WEIGHT <b>0.029 LBS.</b>
CHANGED BY -- DATE --			THE INFORMATION CONTAINED IN THIS DRAWING IS THE SOLE PROPERTY OF PARVUS CORPORATION (PC). ANY REPRODUCTION IN PART OR AS A WHOLE WITHOUT THE WRITTEN PERMISSION OF PC IS PROHIBITED.
CHECKED BY <b>pbabitz</b> DATE <b>02 Aug 12</b>			PROPRIETARY AND CONFIDENTIAL
DRAWN BY <b>pbabitz</b> DATE <b>18 Jan 12</b>			SIZE <b>B</b> CAGE <b>0C0C7</b> DWG NO <b>MCH-2376-01</b> REV <b>A1</b>
			SCALE <b>1:1</b> STATUS <b>RELEASED</b> SHEET <b>1 OF 1</b>